

MATERIALS

Cast bodies: Aluminum Alloy.
Compression bodies: Aluminum - Aluminum Alloy
Forged parts: Steel Alloy
Stamped parts: Steel plate.

PROTECTION AGAINST CORROSION

Hot dip galvanizing according to CSA-G164 and ASTM A153 standards.

STANDARDS

All clamps are manufactured according to standard IEC 61284.
Fasteners: galvanized steel, as per ASTM A325 and ASTM A563 standards.
Forged material: EN-10083 equivalent to ASTM A576.
Cast items of aluminum alloy: EN-1706 equivalent to ANSI A413.0.
Extruded items of aluminum-aluminum alloy: EN-755 equivalent to ASTM B221.
Locking pins: stainless steel AISI 304.

STRAIN CLAMPS

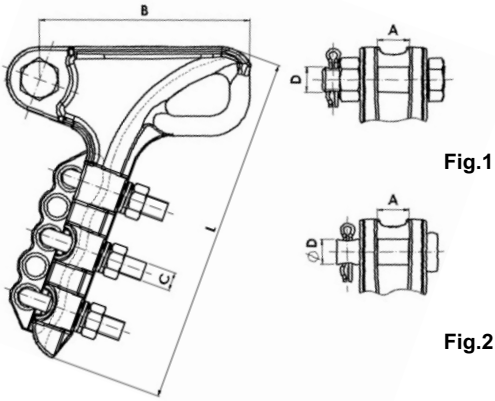

Application: Conductors AAAC, AAC, ACSR,

Material: Body: Aluminum Alloy EN-1706 equivalent to ANSI A413.0.

Bolt: ASTM A325.

Locking pins: Stainless steel.

Nut: ASTM A563.

Steel parts finish: Hot dip galvanizing CSA-G164 and/or ASTM A153.

Reference	Figure	Ø Conductor (inch)		Dimensions (inch)					U-Bolts Nº	Tightening Torque (in-lb)	Ultimate Strength (lb)	Weight (lb)
		Min.	Max.	A	B	C	D	L				
GA-1-PE/AM	Fig.2	0.16	0.47	0.71	3.15	3/8	5/8	4.72	2	220	8,000	0.95
GA-1/AM	Fig.2	0.16	0.47	0.71	4.92	1/2	5/8	6.10	2	310	9,000	1.52
GA-1T/AM	Fig.1	0.16	0.47	0.71	4.92	1/2	5/8	6.10	2	310	9,000	1.54
GA-2/AM	Fig.2	0.39	0.63	0.79	5.30	1/2	5/8	8.78	3	400	15,000	2.51
GA-2T/AM	Fig.1	0.39	0.63	0.79	5.30	1/2	5/8	8.78	3	400	15,000	2.60
GA-2-L/AM	Fig.2	0.35	0.71	0.71	7.87	1/2	5/8	11.02	3	400	15,000	3.44
GA-2T-L/AM	Fig.1	0.35	0.71	0.71	7.87	1/2	5/8	11.02	3	400	15,000	3.55
GA-3/AM	Fig.2	0.63	0.87	1.02	6.61	1/2	5/8	13.39	4	440	19,000	4.03
GA-3T/AM	Fig.1	0.63	0.87	1.02	6.61	1/2	5/8	13.39	4	440	19,000	4.12
GA-3-L/AM	Fig.2	0.55	0.75	1.00	11.50	9/16	5/8	12.60	3	400	15,000	3.97
GA3T-L/AM	Fig.1	0.55	0.75	1.00	11.50	9/16	5/8	12.60	3	400	15,000	4.08
GA-4T/AM	Fig.1	0.79	1.22	1.54	9.65	9/16	5/8	18.11	5	710	30,000	9.33
GA-5T/AM	Fig.1	1.22	1.52	1.79	9.92	9/16	3/4	18.88	5	710	30,000	11.35

NOTE: The clamps can be provided with stainless steel fasteners (except connection screw to fitting string).
Other kinds of fasteners upon request.

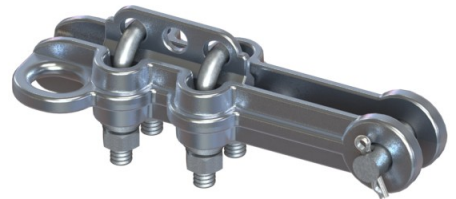
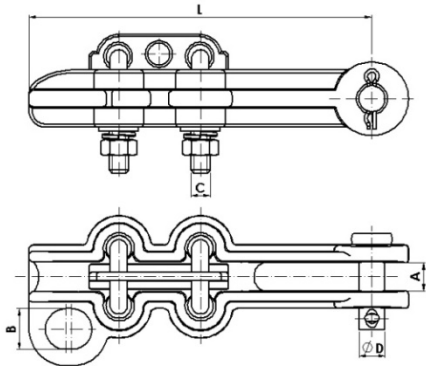

Application: Conductors AAAC, AAC, ACSR

Material: Body: Aluminum Alloy EN-1706 equivalent to ANSI A413.0.

Bolt: ASTM A325.

Locking pins: Stainless steel.

Nut: ASTM A563.

Steel parts finish: Hot dip galvanizing CSA-G164 and/or ASTM A153.

Reference	Ø Conductor (inch)		Dimensions (inch)					Tightening Torque (in-lb)	Ultimate Strength (lb)	Weight (lb)
	Min.	Max.	A	B	C	D	L			
GAR-2/AM	0.43	0.71	0.75	0.98	1/2	5/8	8.27	440	10,000	2.20

NOTE: The clamps can be provided with stainless steel fasteners (except connection screw to fitting string).
Other kinds of fasteners upon request.

COMPRESSION DEAD ENDS AND JOINTS

COMPRESSION DEAD ENDS FOR ACSR CONDUCTORS

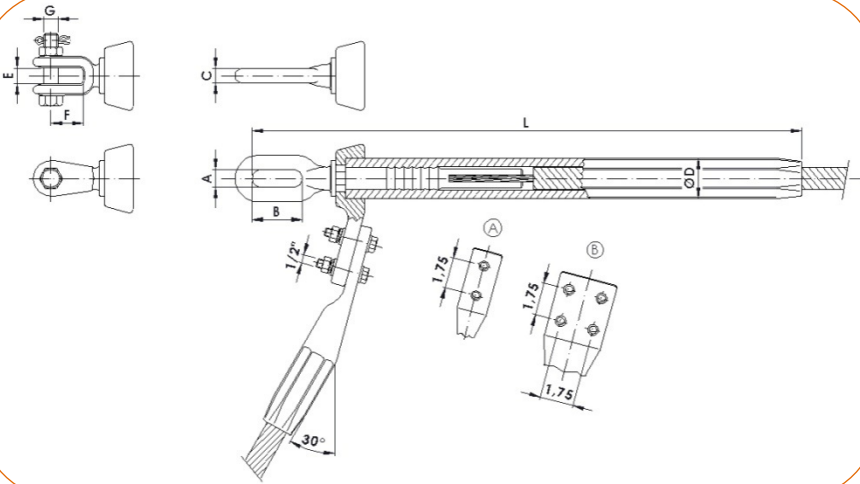

Material: Body: Aluminum EN-755 equivalent to ASTM B221. **Bolt:** ASTM A325.
Nut: ASTM A563.

Locking pins: Stainless steel.
Plunger: Steel EN-10083 equivalent to ASTM A576.

Steel parts finish: Hot dip galvanizing CSA-G164 and/or ASTM A153.

Series	Ø D (inch)	Type of blade	Eye type					Clevis type				
			A (inch)	B (inch)	C (inch)	L (inch)	Weight (lb)	E (inch)	F (inch)	G (inch)	L (inch)	Weight (lb)
E	1.18	A (NEMA 2)	0.87	2.36	0.55	20.67	3.97	0.75	1.77	5/8	19.69	4.41
G	1.52	A (NEMA 2)	0.91	2.17	0.71	23.62	6.61	0.94	1.77	5/8	22.44	7.72
K	1.81	B (NEMA 4)	0.98	2.76	0.79	27.95	11.46	0.94	1.77	3/4	26.18	12.13
L	1.98	B (NEMA 4)	0.98	2.76	0.79	29.53	12.79	0.94	1.77	3/4	27.76	13.23
N	2.22	B (NEMA 4)	0.98	2.76	0.79	30.31	17.64	0.94	1.77	3/4	28.54	16.53
P	2.36	B (NEMA 4)	0.98	2.76	0.79	32.68	18.74	0.94	1.77	3/4	30.91	17.64

NOTE: Other kinds of fasteners upon request.

COMPRESSION DEAD-ENDS FOR ACSR CONDUCTORS HIGHER Ø

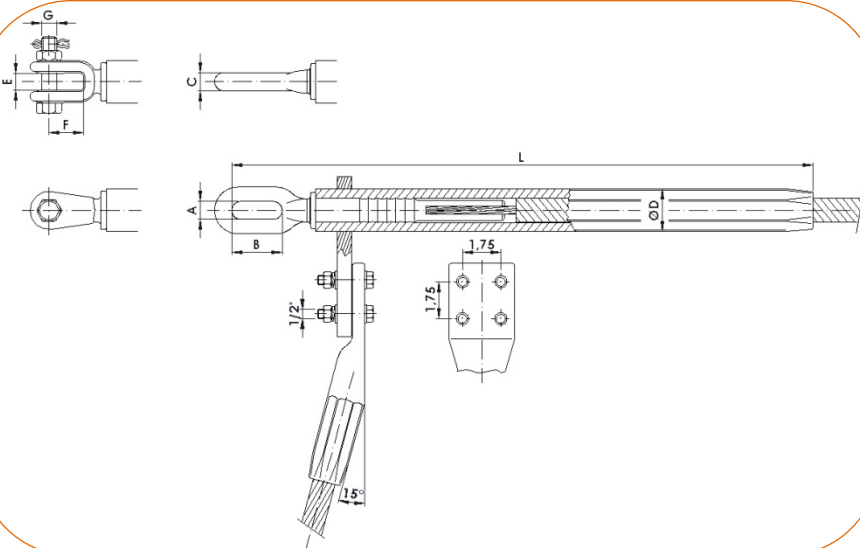

Material: Body: Aluminum EN-755 equivalent to ASTM B221. **Bolt:** ASTM A325.
Nut: ASTM A563.

Locking pins: Stainless steel.

Plunger: Steel EN-10083 equivalent to ASTM A576.

Steel parts finish: Hot dip galvanizing CSA-G164 and/or ASTM A153.

Series	Ø D (inch)	Type of Blade	Eye type					Clevis type				
			A (inch)	B (inch)	C (inch)	L (inch)	Weight (lb)	E (inch)	F (inch)	G (inch)	L (inch)	Weight (lb)
66	2.60	NEMA 4	0.98	2.76	0.79	32.28	20.17	0.94	1.77	3/4	30.51	19.40
75	2.95	NEMA 4	0.98	2.76	0.79	32.09	25.35	0.94	1.77	3/4	24.61	20.39

NOTE: Other kinds of fasteners upon request.

COMPRESSION DEAD ENDS AND JOINTS

LINE END COMPRESSION DEAD-ENDS FOR ACSR CONDUCTORS

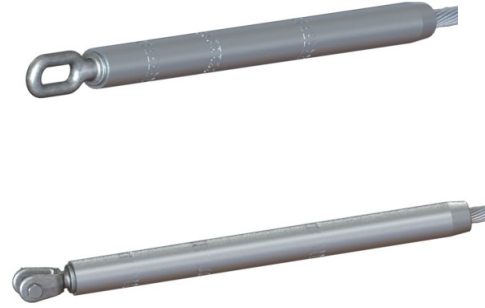
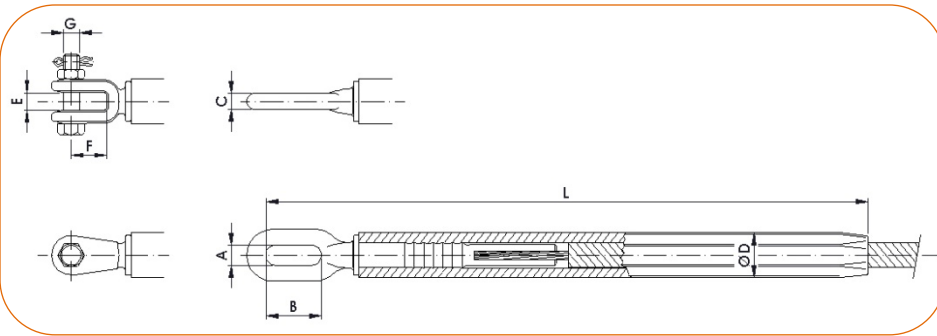

Material: Body: Aluminum EN-755 equivalent to ASTM B221. **Bolt:** ASTM A325.
Nut: ASTM A563.

Locking pins: Stainless steel.

Plunger: Steel EN10083 equivalent to ASTM A576.

Steel parts finish: Hot dip galvanizing CSA-G164 and/or ASTM A153.

Series	Ø D (inch)	Eye type					Clevis type				
		A (inch)	B (inch)	C (inch)	L (inch)	Weight (lb)	E (inch)	F (inch)	G (inch)	L (inch)	Weight (lb)
E	1.18	0.87	2.36	0.55	20.28	2.65	0.75	1.77	5/8	19.29	3.31
G	1.52	0.91	2.17	0.71	23.23	4.41	0.94	1.77	5/8	22.44	5.51
K	1.81	0.98	2.76	0.79	27.56	7.72	0.94	1.77	3/4	25.79	8.27
L	1.98	0.98	2.76	0.79	28.94	8.82	0.94	1.77	3/4	27.36	9.37
N	2.22	0.98	2.76	0.79	29.72	10.47	0.94	1.77	3/4	28.15	11.02
P	2.36	0.98	2.76	0.79	32.09	12.13	0.94	1.77	3/4	30.51	12.68
66	2.60	0.98	2.76	0.79	32.28	13.78	0.94	1.77	3/4	30.51	13.01
75	2.95	0.98	2.76	0.79	32.09	18.96	0.94	1.77	3/4	24.61	14.11

NOTE: Other kinds of fasteners upon request.

COMPRESSION MID-SPAN JOINTS FOR ACSR CONDUCTORS



Material: Aluminum EN-755 equivalent to ASTM B221.

FULL TRACTION JOINTS

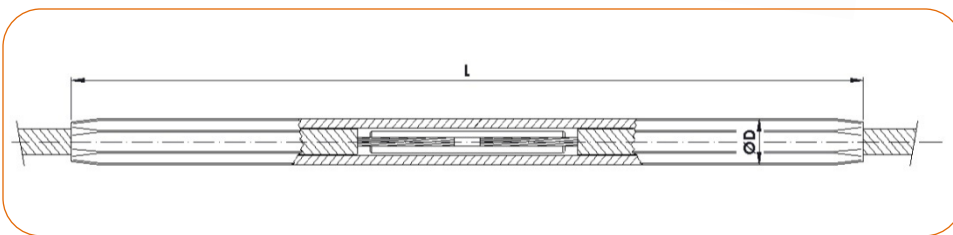

Series	Ø D (inch)	L (inch)	Weight (lb)
E	1.18	23.62	2.20
G	1.52	29.53	4.41
K	1.81	33.46	6.61
L	1.98	35.43	7.72
N	2.22	37.80	9.92
P	2.36	42.52	12.13
66	2.60	42.52	12.90
75	2.95	42.52	14.11

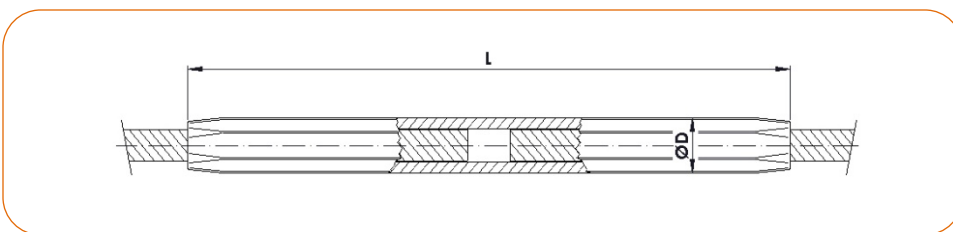

JUMPER JOINTS



Material: Aluminum EN-755 equivalent to ASTM B221.

Series	Ø D (inch)	L (inch)	Weight (lb)
E	1.18	8.27	0.66
G	1.52	9.45	1.10
K	1.81	11.22	1.76
L	1.98	12.01	1.98
N	2.22	13.58	3.09
P	2.36	14.96	3.75
66	2.60	14.96	4.08
75	2.95	14.96	4.63

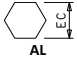
ALUMINUM CONDUCTORS STEEL REINFORCED (ACSR)

Conductor				Compression Fittings					
Code Word	Ø Ext. (inch)	Ø Core (inch)	Size (kcmil)	Compression Dead-end	Compression Joint	Repair Sleeve	Series		
AL-AW 93.26	0.49	0.30	184.11	C(H)-93/AM	EC-93/AM	ER-93/AM	E	1.00	0.53
PIGEON	0.50	0.17	195.81	C(H)-99/AM	EC-99/AM	ER-99/AM	E	1.00	0.39
PHLOX-94-1	0.50	0.33	166.25	C(H)-94-1/AM	EC-94-1/AM	ER-94-1/AM	E	1.00	0.61
RAUMA	0.52	0.29	203.27	C(H)-103/AM	EC-103/AM	ER-103/AM	E	1.00	0.57
LEGHORN	0.53	0.32	213.14	C(H)-108/AM	EC-108/AM	ER-108/AM	E	1.00	0.53
95/15	0.54	0.20	216.50	C(H)-109/AM	EC-109/AM	ER-109/AM	E	1.00	0.39
100-A1/S1A-6/1	0.54	0.18	230.31	C(H)-117/AM	EC-117/AM	ER-117/AM	E	1.00	0.43
LA-110	0.55	0.24	229.32	C(H)-110/AM	EC-110/AM	ER-110/AM	E	1.00	0.43
CROCUS-116.2	0.55	0.24	229.40	C(H)-115/AM	EC-115/AM	ER-115/AM	E	1.00	0.43
CANNA-116.2	0.55	0.24	229.40	C(H)-116/AM	EC-116/AM	ER-116/AM	E	1.00	0.43
DOG	0.56	0.19	233.86	C(H)-118/AM	EC-118/AM	ER-118/AM	E	1.00	0.43
PENGUIN	0.56	0.19	246.89	C(H)-125/AM	EC-125/AM	ER-125/AM	E	1.00	0.43
SPARVIERO	0.57	0.19	248.07	C(H)-126/AM	EC-126/AM	ER-126/AM	E	1.00	0.43
GUINEA	0.57	0.34	251.72	C(H)-127/AM	EC-127/AM	ER-127/AM	E	1.00	0.57
PERNICE	0.58	0.21	254.39	C(H)-128/AM	EC-128/AM	ER-128/AM	E	1.00	0.43
SUSTRONG	0.58	0.25	257.74	C(H)-131/AM	EC-131/AM	ER-131/AM	E	1.00	0.43
DOTTEREL	0.61	0.36	279.59	C(H)-140/AM	EC-140/AM	ER-140/AM	E	1.00	0.63
120/20	0.61	0.22	279.06	C(H)-141/AM	EC-141/AM	ER-141/AM	E	1.00	0.43
LA-145	0.62	0.27	290.31	C(H)-145/AM	EC-145/AM	ER-145/AM	E	1.00	0.49
CROCUS-147.1	0.62	0.27	290.33	C(H)-147/AM	EC-147/AM	ER-147/AM	E	1.00	0.49
PASTEL-147-1	0.62	0.27	290.33	C(H)-147/AM	EC-147/AM	ER-147/AM	E	1.00	0.49
PHLOX-147-1	0.62	0.44	290.31	C(H)-147-1/AM	EC-147-1/AM	ER-147-1/AM	G	1.36	0.75
LEOPARD	0.62	0.21	292.28	C(H)-151/AM	EC-151/AM	ER-151/AM	E	1.00	0.43
OWL	0.63	0.21	301.38	C(H)-152/AM	EC-152/AM	ER-152/AM	E	1.00	0.43
DORKING	0.63	0.38	302.03	C(H)-153/AM	EC-153/AM	ER-153/AM	E	1.00	0.63
PARTRIDGE	0.64	0.24	310.16	C(H)-160/AM	EC-160/AM	ER-160/AM	E	1.00	0.43
125/30	0.64	0.28	311.22	C(H)-158/AM	EC-158/AM	ER-158/AM	E	1.00	0.49
DINGO	0.66	0.13	330.57	C(H)-167/AM	EC-167/AM	ER-167/AM	E	1.00	0.43

ALUMINUM CONDUCTORS STEEL REINFORCED (ACSR)

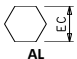
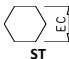
Conductor				Compression Fittings					
Code Word	Ø Ext. (inch)	Ø Core (inch)	Size (kcmil)	Compression Dead-end	Compression Joint	Repair Sleeve	Series		
COCHIN	0.66	0.40	334.63	C(H)-169/AM	EC-169/AM	ER-169/AM	G	1.36	0.75
150/25	0.67	0.25	341.62	C(H)-173/AM	EC-173/AM	ER-173/AM	E	1.00	0.53
OSTRICH	0.68	0.25	348.74	C(H)-176/AM	EC-176/AM	ER-176/AM	E	1.00	0.53
MERLIN	0.68	0.14	355.10	C(H)-179/AM	EC-179/AM	ER-179/AM	E	1.00	0.53
LA-180	0.69	0.30	358.39	C(H)-180/AM	EC-180/AM	ER-180/AM	E	1.00	0.53
CROCUS-181.6	0.69	0.30	358.43	C(H)-181-6/AM	EC-181-6/AM	ER-181-6/AM	E	1.00	0.53
PASTEL-181.6	0.69	0.30	358.43	C(H)-181/AM	EC-181/AM	ER-181/AM	E	1.00	0.53
115/67	0.69	0.41	360.76	C(H)-183/AM	EC-183/AM	ER-183/AM	G	1.36	0.75
PIPER	0.70	0.30	370.00	C(H)-187/AM	EC-187/AM	ER-187/AM	E	1.00	0.53
WOLF	0.71	0.28	384.64	C(H)-195/AM	EC-195/AM	ER-195/AM	E	1.00	0.57
BRAHMA	0.71	0.49	383.95	C(H)-195-AW/AM	EC-195-AW/AM	ER-195-AW/AM	L	1.77	0.87
LINNET	0.72	0.27	391.27	C(H)-198/AM	EC-198/AM	ER-198/AM	E	1.00	0.53
ORIOLE	0.74	0.32	414.95	C(H)-210/AM	EC-210/AM	ER-210/AM	G	1.36	0.57
170/40	0.74	0.32	418.19	C(H)-212/AM	EC-212/AM	ER-212/AM	G	1.36	0.63
185/30	0.75	0.28	421.54	C(H)-213/AM	EC-213/AM	ER-213/AM	G	1.36	0.63
ZIGOLO	0.76	0.28	438.89	C(H)-222/AM	EC-222/AM	ER-222/AM	G	1.36	0.57
LYNX	0.77	0.33	446.41	C(H)-226/AM	EC-226/AM	ER-226/AM	G	1.36	0.63
CROCUS-228	0.77	0.33	449.61	C(H)-228/AM	EC-228/AM	ER-228/AM	G	1.36	0.63
BRANT	0.77	0.26	449.08	C(H)-227/AM	EC-227/AM	ER-227/AM	G	1.36	0.63
IBIS	0.78	0.29	462.18	C(H)-234/AM	EC-234/AM	ER-234/AM	G	1.36	0.57
210/35	0.80	0.29	479.96	C(H)-243/AM	EC-243/AM	ER-243/AM	G	1.36	0.57
LARK	0.80	0.34	490.20	C(H)-248/AM	EC-248/AM	ER-248/AM	G	1.36	0.63
PELICAN	0.81	0.16	503.45	C(H)-255/AM	EC-255/AM	ER-255/AM	G	1.36	0.63
PANTHER	0.83	0.35	516.08	C(H)-260/AM	EC-260/AM	ER-260/AM	G	1.36	0.63
230/30	0.83	0.28	514.50	C(H)-261/AM	EC-261/AM	ER-261/AM	G	1.36	0.63
210/50	0.83	0.35	516.27	C(H)-262/AM	EC-262/AM	ER-262/AM	G	1.36	0.63
TOUCAN	0.83	0.25	523.81	C(H)-265/AM/	EC-265/AM	ER-265/AM	G	1.36	0.63
FLICKER	0.85	0.28	538.71	C(H)-273/AM	EC-273/AM	ER-273/AM	G	1.36	0.63

ALUMINUM CONDUCTORS STEEL REINFORCED (ACSR)

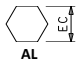
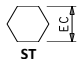
Conductor				Compression Fittings					
Code Word	Ø Ext. (inch)	Ø Core (inch)	Size (kcmil)	Compression Dead-end	Compression Joint	Repair Sleeve	Series	 AL	 ST
HAWK (LA-280)	0.86	0.32	554.76	C(H)-280/AM	EC-280/AM	ER-280/AM	G	1.36	0.63
240/40	0.86	0.32	557.52	C(H)-282/AM	EC-282/AM	ER-282/AM	G	1.36	0.63
LA-250	0.87	0.37	569.07	C(H)-290/AM	EC-290/AM	ER-290/AM	G	1.36	0.69
CROCUS-288	0.87	0.37	569.07	C(H)-288/AM	EC-288/AM	ER-288/AM	G	1.36	0.69
PASTEL-288	0.87	0.37	569.07	C(H)-289/AM	EC-289/AM	ER-289/AM	G	1.36	0.69
OSPREY	0.88	0.18	587.48	C(H)-297/AM	EC-297/AM	ER-297/AM	G	1.36	0.63
265/35	0.88	0.29	587.72	C(H)-300/AM	EC-300/AM	ER-300/AM	G	1.36	0.63
SAPSUCKER	0.90	0.26	611.16	C(H)-310/AM	EC-310/AM	ER-310/AM	G	1.36	0.75
HERON	0.90	0.39	616.63	C(H)-312/AM	EC-312/AM	ER-312/AM	G	1.36	0.75
HEN	0.88	0.38	588.25	C(H)-298/AM	EC-298/AM	ER-298/AM	G	1.36	0.69
PARAKEET	0.91	0.30	628.73	C(H)-318/AM	EC-318/AM	ER-318/AM	G	1.36	0.75
BEAR	0.92	0.40	642.58	C(H)-325/AM	EC-325/AM	ER-325/AM	G	1.36	0.75
DOVE	0.93	0.34	647.20	C(H)-328/AM	EC-328/AM	ER-328/AM	G	1.36	0.75
300/39	0.94	0.31	670.21	C(H)-340/AM	EC-340/AM	ER-340/AM	K	1.56	0.69
DUCK	0.95	0.32	679.88	C(H)-345/AM	EC-345/AM	ER-345/AM	G	1.36	0.63
PEACOCK	0.95	0.32	683.47	C(H)-346/AM	EC-346/AM	ER-346/AM	K	1.56	0.63
EAGLE	0.95	0.41	686.41	C(H)-347/AM	EC-347/AM	ER-347/AM	K	1.56	0.69
300/50	0.96	0.35	698.04	C(H)-354/AM	EC-354/AM	ER-354/AM	K	1.56	0.69
340/30	0.98	0.28	728.43	C(H)-369/AM	EC-369/AM	ER-369/AM	K	1.56	0.63
GROSBEAK	0.99	0.36	739.50	C(H)-374/AM	EC-374/AM	ER-374/AM	K	1.56	0.69
330/53	0.99	0.36	739.72	C(H)-375/AM	EC-375/AM	ER-375/AM	K	1.56	0.63
TEAL	0.99	0.43	742.93	C(H)-376/AM	EC-376/AM	ER-376/AM	K	1.56	0.75
GULL (LA-380)	1.00	0.33	751.91	C(H)-380/AM	EC-380/AM	ER-380/AM	K	1.56	0.63
FLAMINGO	1.00	0.33	753.00	C(H)-381/AM	EC-381/AM	ER-381/AM	K	1.56	0.63
EGRET	1.02	0.44	781.14	C(H)-396/AM	EC-396/AM	ER-396/AM	K	1.56	0.69
CROW	1.03	0.34	808.26	C(H)-409/AM	EC-409/AM	ER-409/AM	K	1.56	0.63
STILT	1.04	0.34	808.26	C(H)-410/AM	EC-410/AM	ER-410/AM	K	1.56	0.63
CROCUS-412	1.04	0.47	812.44	C(H)-411/AM	EC-411/AM	ER-411/AM	K	1.56	0.87

ALUMINUM CONDUCTORS STEEL REINFORCED (ACSR)

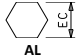
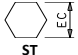
Conductor				Compression Fittings					
Code Word	Ø Ext. (inch)	Ø Core (inch)	Size (kcmil)	Compression Dead-end	Compression Joint	Repair Sleeve	Series		
360/57	1.05	0.39	824.03	C(H)-418/AM	EC-418/AM	ER-418/AM	K	1.56	0.75
385/35	1.05	0.29	829.08	C(H)-420/AM	EC-420/AM	ER-420/AM	K	1.56	0.63
STARLING	1.05	0.39	831.70	C(H)-421/AM	EC-421/AM	ER-421/AM	K	1.56	0.75
BISON	1.06	0.35	851.18	C(H)-431/AM	EC-431/AM	ER-431/AM	K	1.56	0.75
380/50	1.06	0.35	851.58	C(H)-432/AM	EC-432/AM	ER-432/AM	K	1.56	0.75
REDWING	1.08	0.46	878.53	C(H)-444/AM	EC-444/AM	ER-444/AM	K	1.56	0.75
CONDOR (LA-455)	1.09	0.36	896.97	C(H)-455/AM	EC-455/AM	ER-455/AM	K	1.56	0.75
DRAKE	1.11	0.41	924.50	C(H)-468/AM	EC-468/AM	ER-468/AM	K	1.56	0.75
ZEBRA	1.13	0.38	956.17	C(H)-480/AM	EC-480/AM	ER-480/AM	K	1.56	0.75
450/40	1.13	0.32	963.48	C(H)-488/AM	EC-488/AM	ER-488/AM	K	1.56	0.63
435/55	1.13	0.38	968.21	C(H)-490/AM	EC-490/AM	ER-490/AM	K	1.56	0.75
MALLARD	1.14	0.49	956.59	C(H)-484/AM	EC-484/AM	ER-484/AM	L	1.77	0.87
CRANE	1.14	0.38	988.10	C(H)-501/AM	EC-501/AM	ER-501/AM	L	1.77	0.75
CANARY	1.16	0.39	1016.68	C(H)-514/AM	EC-514/AM	ER-514/AM	L	1.77	0.87
RAIL	1.17	0.29	1020.00	C(H)-515/AM	EC-515/AM	ER-515/AM	L	1.77	0.63
495/35	1.18	0.29	1042.42	C(H)-528/AM	EC-528/AM	ER-528/AM	L	1.77	0.63
CAMEL	1.19	0.40	1059.39	C(H)-537/AM	EC-537/AM	ER-537/AM	L	1.77	0.87
CARDINAL (LA-545)	1.20	0.40	1080.11	C(H)-540/AM	EC-540/AM	ER-540/AM	L	1.77	0.87
490/65	1.20	0.40	1093.14	C(H)-554/AM	EC-554/AM	ER-554/AM	L	1.77	0.87
510/45	1.21	0.34	1096.29	C(H)-555/AM	EC-555/AM	ER-555/AM	L	1.77	0.75
CURLEW	1.25	0.42	1167.44	C(H)-590/AM	EC-590/AM	ER-590/AM	L	1.77	0.87
ZAMBEZE	1.25	0.27	1173.26	C(H)-594/AM	EC-594/AM	ER-594/AM	L	1.77	0.75
BLUEJAY	1.26	0.31	1189.96	C(H)-603/AM	EC-603/AM	ER-603/AM	L	1.77	0.75
570/40	1.27	0.32	1204.44	C(H)-610/AM	EC-610/AM	ER-610/AM	N	1.93	0.63
560/50	1.27	0.35	1206.22	C(H)-611/AM	EC-611/AM	ER-611/AM	N	1.93	0.63
PHLOX-612	1.27	0.52	1207.36	C(H)-612/AM	EC-612/AM	ER-612/AM	N	1.93	0.93
550/70	1.28	0.43	1226.15	C(H)-621/AM	EC-621/AM	ER-621/AM	N	1.93	0.87
BUNTING	1.30	0.33	1274.52	C(H)-646/AM	EC-646/AM	ER-646/AM	N	1.93	0.87

ALUMINUM CONDUCTORS STEEL REINFORCED (ACSR)

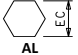
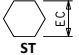
Conductor				Compression Fittings					
Code Word	Ø Ext. (inch)	Ø Core (inch)	Size (kcmil)	Compression Dead-end	Compression Joint	Repair Sleeve	Series	 AL	 ST
FINCH (LA-635)	1.29	0.43	1058.99	C(H)-635/AM	EC-635/AM	ER-635/AM	N	1.93	0.87
SCISSORTAIL	1.33	0.29	1337.40	C(H)-678/AM	EC-678/AM	ER-678/AM	N	1.93	0.69
GRACKLE	1.34	0.45	1343.65	C(H)-680/AM	EC-680/AM	ER-680/AM	N	1.93	0.87
632/45	1.34	0.34	1336.87	C(H)-677/AM	EC-677/AM	ER-677/AM	N	1.93	0.75
BITTERN	1.35	0.34	1359.82	C(H)-689/AM	EC-689/AM	ER-689/AM	N	1.93	0.75
PHEASANT	1.38	0.46	1433.15	C(H)-726/AM	EC-726/AM	ER-726/AM	N	1.93	0.87
DIPPER	1.38	0.34	1444.50	C(H)-732/AM	EC-732/AM	ER-732/AM	N	1.93	0.75
680/85	1.42	0.47	1509.35	C(H)-765/AM	EC-765/AM	ER-765/AM	P	2.05	1.02
MARTIN	1.42	0.47	1522.67	C(H)-771/AM	EC-771/AM	ER-771/AM	P	2.05	0.87
BOBOLINK	1.43	0.36	1530.31	C(H)-775/AM	EC-775/AM	ER-775/AM	P	2.05	0.87
NUTHATCH	1.46	0.37	1614.84	C(H)-818/AM	EC-818/AM	ER-818/AM	P	2.05	0.87
PLOVER	1.47	0.49	1612.31	C(H)-817/AM	EC-817/AM	ER-817/AM	P	2.05	0.87
LAPWING	1.50	0.38	1699.52	C(H)-860/AM	EC-860/AM	ER-860/AM	P	2.05	0.87
PARROT	1.51	0.50	1701.55	C(H)-862/AM	EC-862/AM	ER-862/AM	P	2.05	0.87
FALCON	1.55	0.52	1791.59	C(H)-908/AM	EC-908/AM	ER-908/AM	P	2.05	0.87
CHUKAR	1.68	0.44	1927.54	C(H)-977/AM	EC-977/AM	ER-977/AM	66	2.24	0.87

COMPRESSION DEAD ENDS AND JOINTS

COMPRESSION DEAD ENDS FOR AAC, AAAC, ACAR CONDUCTORS

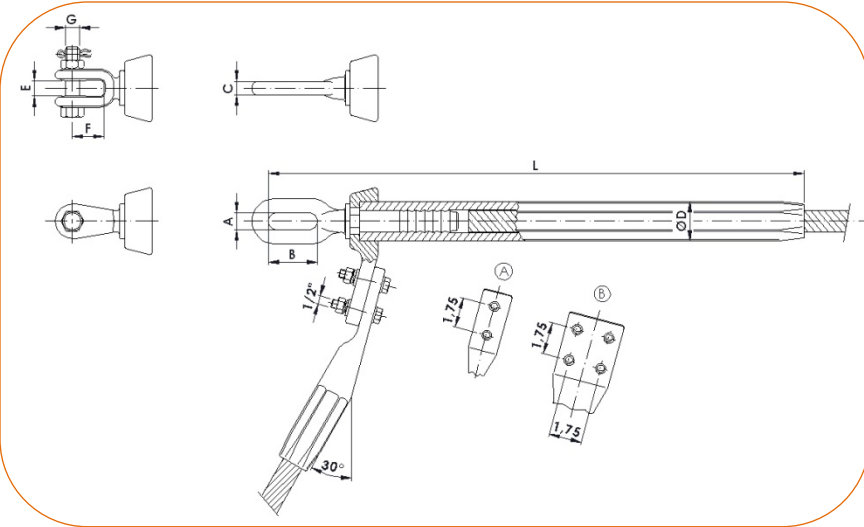

Material: Body: Aluminum Alloy EN-755 equivalent to ASTM B221 (AAAC, ACAR) **Bolt:** ASTM A325. **Locking pins:** Stainless steel
 Aluminum. EN-755 equivalent to ASTM B221 (AAC) **Nut:** ASTM A563. **Plunger:** Steel EN-10083 equivalent to ASTM A576.
Steel parts finish: Hot dip galvanizing CSA-G164 and/or ASTM A153.

Series	Ø D (inch)	Type of Blade	Eye type				Weight (lb)	Clevis type				Weight (lb)
			A (inch)	B (inch)	C (inch)	L (inch)		E (inch)	F (inch)	G (inch)	L (inch)	
E	1.18	A (NEMA2)	0.87	2.36	0.55	17.32	3.31	0.75	1.77	5/8	16.34	4.41
G	1.52	A (NEMA2)	0.91	2.17	0.71	19.29	5.95	0.94	1.77	5/8	18.11	7.05
K	1.81	B (NEMA 4)	0.98	2.76	0.79	22.24	9.92	0.94	1.77	3/4	20.67	11.02
L	1.98	B (NEMA 4)	0.98	2.76	0.79	24.41	11.02	0.94	1.77	3/4	22.83	12.13
N	2.22	B (NEMA 4)	0.98	2.76	0.79	28.15	14.88	0.94	1.77	3/4	26.57	14.33
P	2.36	B (NEMA 4)	0.98	2.76	0.79	28.94	15.98	0.94	1.77	3/4	27.17	14.88

NOTE: Other kinds of fasteners upon request.

COMPRESSION DEAD ENDS FOR AAC, AAAC AND ACAR CONDUCTORS, HIGHER Ø

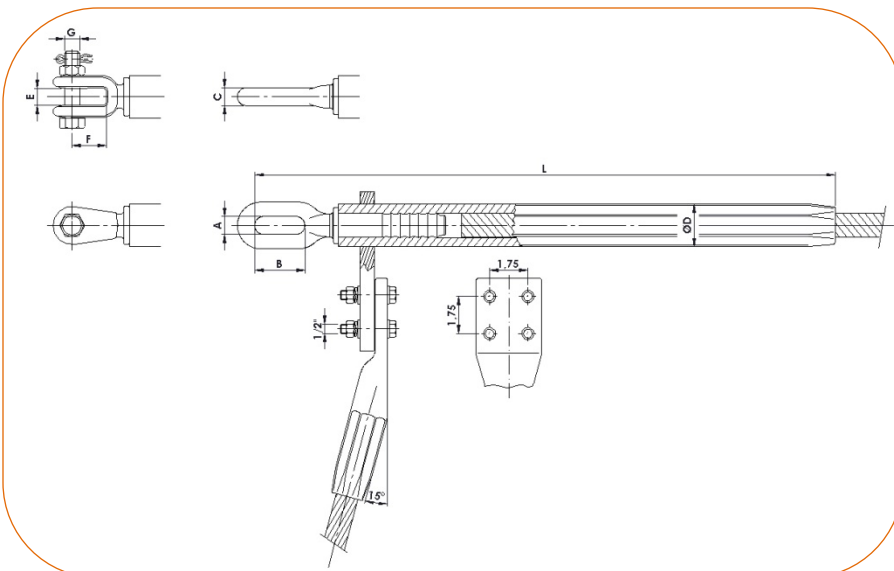

Material: Body: Aluminum Alloy EN-755 equivalent to ASTM B221 (AAAC, ACAR) **Bolt:** ASTM A325. **Locking pins:** Stainless steel
 Aluminum. EN-755 equivalent to ASTM B221 (AAC) **Nut:** ASTM A563. **Plunger:** Steel EN-10083 equivalent to ASTM A576.
Steel parts finish: Hot dip galvanizing CSA-G164 and/or ASTM A153.

Series	Ø D (inch)	Pad type	Eye type				Weight (lb)	Clevis type				Weight (lb)
			A (inch)	B (inch)	C (inch)	L (inch)		E (inch)	F (inch)	G (inch)	L (inch)	
66	2.60	NEMA 4	0.98	2.76	0.79	32.28	20.17	0.94	1.77	3/4	30.51	19.40
75	2.95	NEMA 4	0.98	2.76	0.79	32.09	25.35	0.94	1.77	3/4	24.61	20.39

NOTE: Other kinds of fasteners upon request.

COMPRESSION DEAD ENDS AND JOINTS

LINE END COMPRESSION DEAD-ENDS FOR AAC, AAAC AND ACAR CONDUCTORS

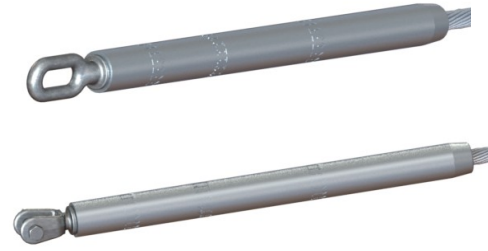
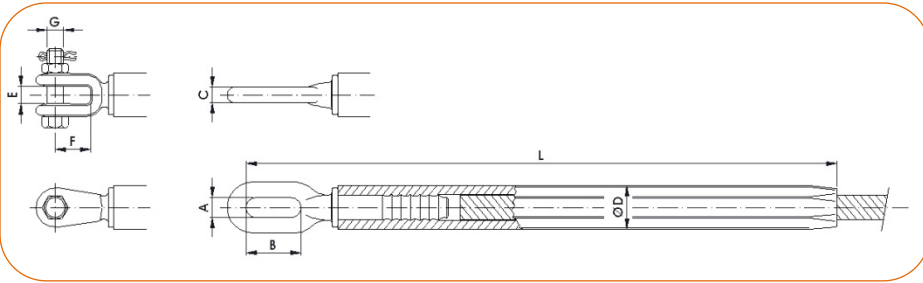

Material: Body: Aluminum Alloy EN-755 equivalent to ASTM B221 (AAAC, ACAR) **Bolt:** ASTM A325. **Locking pins:** Stainless steel
 Aluminum. EN-755 equivalent to ASTM B221 (AAC) **Nut:** ASTM A563. **Plunger:** Steel EN-10083 equivalent to ASTM A576.
Steel parts finish: Hot dip galvanizing CSA-G164 and/or ASTM A153.

Series	Ø D (inch)	Eye type					Clevis type				
		A (inch)	B (inch)	C (inch)	L (inch)	Weight (lb)	E (inch)	F (inch)	G (inch)	L (inch)	Weight (lb)
E	1.18	0.87	2.36	0.55	17.13	2.20	0.75	1.77	5/8	15.94	2.65
G	1.52	0.91	2.17	0.71	18.90	3.75	0.94	1.77	5/8	17.72	5.07
K	1.81	0.98	2.76	0.79	21.85	6.17	0.94	1.77	3/4	20.28	6.61
L	1.98	0.98	2.76	0.79	24.02	7.17	0.94	1.77	3/4	22.44	7.72
N	2.22	0.98	2.76	0.79	27.76	8.27	0.94	1.77	3/4	26.18	8.82
P	2.36	0.98	2.76	0.79	28.35	8.82	0.94	1.77	3/4	26.77	10.47
66	2.60	0.98	2.76	0.79	32.28	13.78	0.94	1.77	3/4	30.51	13.01
75	2.95	0.98	2.76	0.79	32.09	18.96	0.94	1.77	3/4	24.61	14.11

NOTE: Other kinds of fasteners upon request.

COMPRESSION MID-SPAN JOINTS FOR AAC, AAAC AND ACAR CONDUCTORS



Material: Body: Alloy A1 . EN-755 equivalent to ASTM B221 (AAAC, ACAR)
 Aluminum. EN-755 equivalent to ASTM B221 (AAC)

FULL TRACTION JOINTS

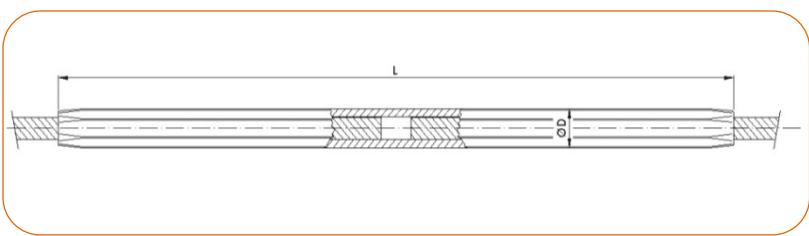

Series	Ø D (inch)	L (inch)	Weight (lb)
E	1.18	18.31	1.10
G	1.52	21.06	1.76
K	1.81	23.82	3.09
L	1.98	27.56	3.31
N	2.22	33.46	4.41
P	2.36	35.43	5.51
66	2.60	35.43	8.16
75	2.95	35.43	9.92

JUMPER JOINTS

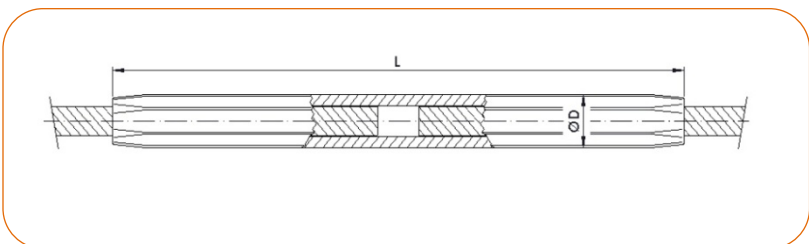

Material: Body: Alloy A1 . EN-755 equivalent to ASTM B221 (AAAC, ACAR)
 Aluminum. EN-755 equivalent to ASTM B221 (AAC)

Series	Ø D (inch)	L (inch)	Weight (lb)
E	1.18	8.27	0.66
G	1.52	9.45	1.10
K	1.81	11.22	1.76
L	1.98	12.01	1.98
N	2.22	13.58	3.09
P	2.36	14.96	3.75
66	2.60	14.96	4.08
75	2.95	14.96	4.63

ALL ALUMINUM CONDUCTORS (AAC)

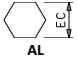
Conductor			Compression Fittings				
Code Word	Ø Ext. (inch)	Size (kcmil)	Compression Dead-end	Compression Joint	Repair Sleeve	Series	
AAC-93.3	0.49	184.07	C(H)-93-A/AM	EC-93-A/AM	ER-93-A/AM	E	1.00
AAC-95	0.49	184.07	C(H)-95-A/AM	EC-95-A/AM	ER-95-A/AM	E	1.00
OXLIP	0.52	211.62	C(H)-107-A/AM	EC-107-A/AM	ER-107-A/AM	E	1.00
L-110	0.55	230.90	C(H)-110-A/AM	EC-110-A/AM	ER-110-A/AM	E	1.00
AAC-117	0.55	230.86	C(H)-117-A/AM	EC-117-A/AM	ER-117-A/AM	E	1.00
AAC-120	0.55	230.90	C(H)-120-A/AM	EC-120-A/AM	ER-120-A/AM	E	1.00
DAISY	0.59	266.74	C(H)-135-A/AM	EC-135-A/AM	ER-135-A/AM	E	1.00
AAC-150	0.62	290.31	C(H)-150-A/AM	EC-150-A/AM	ER-150-A/AM	E	1.00
L-145	0.62	292.28	C(H)-145-A/AM	EC-145-A/AM	ER-145-A/AM	E	1.00
AAC-148	0.62	292.10	C(H)-148-A/AM	EC-148-A/AM	ER-148-A/AM	E	1.00
TULIP	0.67	336.39	C(H)-170-A/AM	EC-170-A/AM	ER-170-A/AM	E	1.00
AAC-185	0.69	358.39	C(H)-185-A/AM	EC-185-A/AM	ER-185-A/AM	E	1.00
L-180	0.70	371.22	C(H)-180-A/AM	EC-180-A/AM	ER-180-A/AM	E	1.00
AAC-188	0.70	371.14	C(H)-188-A/AM	EC-188-A/AM	ER-188-A/AM	E	1.00
CANNA	0.72	397.51	C(H)-201-A/AM	EC-201-A/AM	ER-201-A/AM	E	1.00
AAC-228	0.77	449.63	C(H)-228-A/AM	EC-228-A/AM	ER-228-A/AM	G	1.30
COSMOS	0.79	476.96	C(H)-241-A/AM	EC-241-A/AM	ER-241-A/AM	G	1.30
AAC-240	0.80	478.58	C(H)-240-A/AM	EC-240-A/AM	ER-240-A/AM	G	1.30
AAC-500MCM	0.81	500.00	C(H)-252-A/AM	EC-252-A/AM	ER-252-A/AM	G	1.30
L-280	0.85	551.21	C(H)-280-A/AM	EC-280-A/AM	ER-280-A/AM	G	1.30
DAHLIA	0.86	556.53	C(H)-282-A/AM	EC-282-A/AM	ER-282-A/AM	G	1.30
AAC-288	0.87	569.05	C(H)-288-A/AM	EC-288-A/AM	ER-288-A/AM	G	1.30
AAC-300	0.89	590.87	C(H)-300-A/AM	EC-300-A/AM	ER-300-A/AM	G	1.30
MEADOWSWEET	0.89	599.95	C(H)-304-A/AM	EC-304-A/AM	ER-304-A/AM	G	1.30
ORCHID	0.92	635.97	C(H)-322-A/AM	EC-322-A/AM	ER-322-A/AM	G	1.30
VERBENA	0.96	700.03	C(H)-354-A/AM	EC-354-A/AM	ER-354-A/AM	G	1.30
VIOLET	0.97	715.56	C(H)-362-A/AM	EC-362-A/AM	ER-362-A/AM	G	1.30
AAC-366	0.98	722.74	C(H)-366-A/AM	EC-366-A/AM	ER-366-A/AM	G	1.30

ALL ALUMINUM CONDUCTORS (AAC)

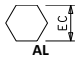
Conductor			Compression Fittings				
Code Word	Ø Ext. (inch)	Size (kcmil)	Compression Dead-end	Compression Joint	Repair Sleeve	Series	
PETUNIA	1.00	749.94	C(H)-380-A/AM	EC-380-A/AM	ER-380-A/AM	K	1.56
L-400	1.00	751.91	C(H)-381-A/AM	EC-381-A/AM	ER-381-A/AM	K	1.56
AAC-400	1.02	789.61	C(H)-400-A/AM	EC-400-A/AM	ER-400-A/AM	K	1.56
ARBUTUS	1.03	795.01	C(H)-403-A/AM	EC-403-A/AM	ER-403-A/AM	K	1.56
LILAC	1.03	795.73	C(H)-404-A/AM	EC-404-A/AM	ER-404-A/AM	K	1.56
ANEMONE	1.08	876.84	C(H)-445-A/AM	EC-445-A/AM	ER-445-A/AM	K	1.56
L-450	1.09	896.97	C(H)-450-A/AM	EC-450-A/AM	ER-450-A/AM	K	1.56
AAC-475	1.12	938.17	C(H)-475-A/AM	EC-475-A/AM	ER-475-A/AM	K	1.56
MAGNOLIA	1.12	954.04	C(H)-483-A/AM	EC-483-A/AM	ER-483-A/AM	K	1.56
AAC-500	1.15	986.37	C(H)-500-A/AM	EC-500-A/AM	ER-500-A/AM	L	1.71
CAMELLIA	1.16	1000.00	C(H)-506-A/AM	EC-506-A/AM	ER-506-A/AM	K	1.56
BLUEBELL	1.17	1033.50	C(H)-523-A/AM	EC-523-A/AM	ER-523-A/AM	L	1.71
LARKSPUR	1.17	1033.50	C(H)-524-A/AM	EC-524-A/AM	ER-524-A/AM	L	1.71
L-550	1.20	1080.11	C(H)-550-A/AM	EC-550-A/AM	ER-550-A/AM	L	1.71
MARIGOLD	1.22	1112.93	C(H)-564-A/AM	EC-564-A/AM	ER-564-A/AM	N	1.91
HAWTHORN	1.22	1192.52	C(H)-605-A/AM	EC-605-A/AM	ER-605-A/AM	N	1.91
AAC-604	1.26	1191.58	C(H)-604-A/AM	EC-604-A/AM	ER-604-A/AM	N	1.91
AAC-625	1.28	1235.82	C(H)-625-A/AM	EC-625-A/AM	ER-625-A/AM	N	1.91
L-630	1.29	1259.70	C(H)-630-A/AM	EC-630-A/AM	ER-630-A/AM	N	1.91
NARCISSUS	1.30	1271.96	C(H)-644-A/AM	EC-644-A/AM	ER-644-A/AM	N	1.91
COLUMBINE	1.34	1351.55	C(H)-685-A/AM	EC-685-A/AM	ER-685-A/AM	N	1.91
CARNATION	1.38	1431.00	C(H)-725-A/AM	EC-725-A/AM	ER-725-A/AM	P	2.05
GLADIOLUS	1.38	1510.44	C(H)-765-A/AM	EC-765-A/AM	ER-765-A/AM	P	2.05
COREOPSIS	1.44	1590.03	C(H)-805-A/AM	EC-805-A/AM	ER-805-A/AM	P	2.05
AAC-800	1.45	1582.96	C(H)-800-A/AM	EC-800-A/AM	ER-800-A/AM	P	2.05
JESSAMINE	1.52	1749.94	C(H)-886-A/AM	EC-886-A/AM	ER-886-A/AM	P	2.05
AAC-1000	1.62	1972.93	C(H)-1000-A/AM	EC-1000-A/AM	ER-1000-A/AM	66	2.24
COWSLIP	1.63	1994.05	C(H)-1013-A/AM	EC-1013-A/AM	ER-1013-A/AM	66	2.24

ALL ALUMINUM CONDUCTORS (AAC)

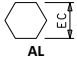
Conductor			Compression Fittings				
Code Word	Ø Ext. (inch)	Size (kcmil)	Compression Dead-end	Compression Joint	Repair Sleeve	Series	
SAGEBRUSH	1.73	2245.48	C(H)-1137-A/AM	EC-1137-A/AM	ER-1137-A/AM	66	2.24
AAC-1250	1.81	2464.93	C(H)-1250-A/AM	EC-1250-A/AM	ER-1250-A/AM	66	2.24
LUPINE	1.82	2499.81	C(H)-1266-A/AM	EC-1266-A/AM	ER-1266-A/AM	66	2.24
BLUEBONNET	2.16	3499.61	C(H)-1773-A/AM	EC-1773-A/AM	ER-1773-A/AM	75	2.54

ALL ALUMINUM ALLOY CONDUCTORS (AAAC)

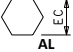
Conductor			Compression Fittings				
Code Word	Ø Ext. (inch)	Size (kcmil)	Compression Dead-end	Compression Joint	Repair Sleeve	Series	
AAAC-95/AMS 95	0.49	184.07	C(H)-95-AA/AM	EC-95-AA/AM	ER-95-AA/AM	E	1.00
AMHERST	0.50	195.81	C(H)-99-AA/AM	EC-99-AA/AM	ER-99-AA/AM	E	1.00
AAAC-112	0.53	220.68	C(H)-112-AA/AM	EC-112-AA/AM	ER-112-AA/AM	E	1.00
OAK	0.55	234.65	C(H)-119-AA/AM	EC-119-AA/AM	ER-119-AA/AM	E	1.00
D-110	0.55	230.90	C(H)-110-AA/AM	EC-110-AA/AM	ER-110-AA/AM	E	1.00
ASTER-117	0.55	230.86	C(H)-117-AA/AM	EC-117-AA/AM	ER-117-AA/AM	E	1.00
AAAC-120	0.55	230.90	C(H)-120-AA/AM	EC-120-AA/AM	ER-120-AA/AM	E	1.00
ALLIANCE	0.56	246.89	C(H)-125-AA/AM	EC-125-AA/AM	ER-125-AA/AM	E	1.00
AAAC-150	0.62	290.31	C(H)-150-AA/AM	EC-150-AA/AM	ER-150-AA/AM	E	1.00
D-145	0.62	292.28	C(H)-145-AA/AM	EC-145-AA/AM	ER-145-AA/AM	E	1.00
ASTER-148	0.62	292.10	C(H)-148-AA/4/AM	EC-148-AA/AM	ER-148-AA/AM	E	0.91
AAAC-149	0.63	295.44	C(H)-149-AA/AM	EC-149-AA/AM	ER-149-AA/AM	E	1.00
MULBERRY	0.63	298.20	C(H)-151-AA/AM	EC-151-AA/AM	ER-151-AA/AM	E	1.00
BUTTE	0.64	313.00	C(H)-158-AA/AM	EC-158-AA/AM	ER-158-AA/AM	E	1.00
AAAC-160	0.64	315.76	C(H)-160-AA/AM	EC-160-AA/AM	ER-160-AA/AM	E	1.00
ASH	0.69	356.62	C(H)-182-AA/AM	EC-182-AA/AM	ER-182-AA/AM	E	1.00
AAAC-185	0.69	358.39	C(H)-185-AA/AM	EC-185-AA/AM	ER-185-AA/AM	E	1.00
ASTER-181-6	0.69	358.43	C(H)-181-AA/4/AM	EC-181-AA/AM	ER-181-AA/AM	E	1.00
D-180	0.70	371.22	C(H)-180-AA/AM	EC-180-AA/AM	ER-180-AA/AM	E	1.00
CANTON	0.72	394.51	C(H)-200-AA/AM	EC-200-AA/AM	ER-200-AA/AM	E	1.00
AAAC-400MCM	0.73	400.00	C(H)-203-AA/AM	EC-203-AA/AM	ER-203-AA/AM	E	1.00
ELM	0.74	416.41	C(H)-211-AA/AM	EC-211-AA/AM	ER-211-AA/AM	E	1.00
ASTER-228	0.77	449.63	C(H)-228-AA/AM	EC-228-AA/AM	ER-228-AA/AM	G	1.30
CAIRO	0.78	465.36	C(H)-236-AA/AM	EC-236-AA/AM	ER-236-AA/AM	G	1.30
POPLAR	0.79	471.67	C(H)-239-AA/AM	EC-239-AA/AM	ER-239-AA/AM	G	1.30
AAAC-240	0.80	478.58	C(H)-240-AA/AM	EC-240-AA/AM	ER-240-AA/AM	G	1.30
AAAC-250	0.81	493.38	C(H)-250-AA/AM	EC-250-AA/AM	ER-250-AA/AM	G	1.30
AMS-2Z-301	0.83	594.52	C(H)-301-AA/AM	EC-301-AA/AM	ER-301-AA/AM	K	1.56

ALL ALUMINUM ALLOY CONDUCTORS (AAAC)

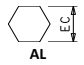
Conductor			Compression Fittings				
Code Word	Ø Ext. (inch)	Size (kcmil)	Compression Dead-end	Compression Joint	Repair Sleeve	Series	
D-280	0.85	551.21	C(H)-280-AA/AM	EC-280-AA/AM	ER-280-AA/AM	G	1.30
DARIEN	0.86	559.49	C(H)-283-AA/AM	EC-283-AA/AM	ER-283-AA/AM	G	1.30
ASTER-288	0.87	569.05	C(H)-288-AA/AM	EC-288-AA/AM	ER-288-AA/AM	G	1.30
AAAC-300	0.89	590.87	C(H)-300-AA/AM	EC-300-AA/AM	ER-300-AA/AM	G	1.30
SYCAMORE	0.89	597.98	C(H)-303-AA/AM	EC-303-AA/AM	ER-303-AA/AM	G	1.30
AAAC-600MCM	0.89	600.00	C(H)-304-AA/AM	EC-304-AA/AM	ER-304-AA/AM	G	1.30
ELGIN	0.93	652.45	C(H)-330-AA/AM	EC-330-AA/AM	ER-330-AA/AM	G	1.30
AAAC-650MCM	0.93	650.00	C(H)-329-AA/AM	EC-329-AA/AM	ER-329-AA/AM	G	1.30
AAAC-700MCM	0.96	700.00	C(H)-355-AA/AM	EC-355-AA/AM	ER-355-AA/AM	G	1.30
UPAS	0.97	714.61	C(H)-362-AA/AM	EC-362-AA/AM	ER-362-AA/AM	K	1.56
ASTER-366	0.98	722.74	C(H)-366-AA/AM	EC-366-AA/AM	ER-366-AA/AM	K	1.56
FLINT	0.99	740.66	C(H)-375-AA/AM	EC-375-AA/AM	ER-375-AA/AM	K	1.56
AAAC-750MCM	0.99	750.00	C(H)-380-AA/AM	EC-380-AA/AM	ER-380-AA/AM	K	1.56
D-400	1.00	751.91	C(H)-381-AA/AM	EC-381-AA/AM	ER-381-AA/AM	K	1.56
AAAC-400	1.02	789.61	C(H)-400-AA/AM	EC-400-AA/AM	ER-400-AA/AM	K	1.56
AERO 455-2Z	1.02	898.23	C(H)-455-AA/AM	EC-455-AA/AM	ER-455-AA/AM	K	1.56
AAAC-800MCM	1.03	800.00	C(H)-405-AA/AM	EC-405-AA/AM	ER-405-AA/AM	K	1.56
AAAC-875MCM	1.08	875.00	C(H)-442-AA/AM	EC-442-AA/AM	ER-442-AA/AM	K	1.56
D-450	1.09	896.97	C(H)-450-AA/AM	EC-450-AA/AM	ER-450-AA/AM	K	1.56
AAAC-900MCM	1.09	900.00	C(H)-456-AA/AM	EC-456-AA/AM	ER-456-AA/AM	K	1.56
GREELEY	1.11	927.16	C(H)-470-AA/AM	EC-470-AA/AM	ER-470-AA/AM	K	1.56
YEW	1.12	947.09	C(H)-480-AA/AM	EC-480-AA/AM	ER-480-AA/AM	L	1.71
AAAC-491	1.14	969.00	C(H)-491-AA/AM	EC-491-AA/AM	ER-491-AA/AM	K	1.56
AAAC-500	1.15	986.37	C(H)-500-AA/AM	EC-500-AA/AM	ER-500-AA/AM	L	1.71
AAAC-506	1.15	998.60	C(H)-506-AA/AM	EC-506-AA/AM	ER-506-AA/AM	L	1.71
AAAC-1000MCM	1.15	1000.00	C(H)-507-AA/AM	EC-507-AA/AM	ER-507-AA/AM	L	1.71
D-550	1.20	1080.11	C(H)-550-AA/AM	EC-550-AA/AM	ER-550-AA/AM	L	1.71
AAAC-1100MCM	1.21	1100.00	C(H)-557-AA/AM	EC-557-AA/AM	ER-557-AA/AM	L	1.71

ALL ALUMINUM ALLOY CONDUCTORS (AAAC)

Conductor			Compression Fittings				
Code Word	Ø Ext. (inch)	Size (kcmil)	Compression Dead-end	Compression Joint	Repair Sleeve	Series	
AAAC-560	1.21	1105.17	C(H)-560-AA/AM	EC-560-AA/AM	ER-560-AA/AM	N	1.91
ASTER-570	1.22	1125.34	C(H)-570-AA/AM	EC-570-AA/AM	ER-570-AA/AM	N	1.91
AAAC-600	1.22	1192.01	C(H)-604-AA/AM	EC-604-AA/AM	ER-604-AA/AM	N	1.91
RUBUS	1.24	1157.67	C(H)-586-AA/AM	EC-586-AA/AM	ER-586-AA/AM	N	1.91
AAAC-625	1.28	1235.82	C(H)-625-AA/AM	EC-625-AA/AM	ER-625-AA/AM	N	1.91
D-630	1.29	1259.70	C(H)-630-AA/AM	EC-630-AA/AM	ER-630-AA/AM	N	1.91
AAAC-1300MCM	1.31	1300.00	C(H)-660-AA/AM	EC-660-AA/AM	ER-660-AA/AM	N	1.91
AAAC-683,4	1.33	1348.71	C(H)-683-AA/AM	EC-683-AA/AM	ER-683-AA/AM	N	1.91
AAAC-732	1.39	1444.62	C(H)-732-AA/AM	EC-732-AA/AM	ER-732-AA/AM	P	2.05
AAAC-1500MCM	1.41	1500.00	C(H)-760-AA/AM	EC-760-AA/AM	ER-760-AA/AM	P	2.05
AAAC-800	1.45	1582.94	C(H)-800-AA/AM	EC-800-AA/AM	ER-800-AA/AM	P	2.05

ALUMINUM CONDUCTORS ALLOY REINFORCED (ACAR)

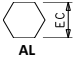
Conductor			Compression Fittings				
Code Word	Ø Ext. (inch)	Size (kcmil)	Compression Dead-end	Compression Joint	Repair Sleeve	Series	
195.7	0.50	195.70	C(H)-98-AA/AM	EC-98-AA/AM	ER-98-AA/AM	E	1.00
4/0	0.52	211.18	C(H)-107-AA/AM	EC-107-AA/AM	ER-107-AA/AM	E	1.00
246.9	0.56	246.90	C(H)-124-AA/AM	EC-124-AA/AM	ER-124-AA/AM	E	1.00
250	0.57	250.00	C(H)-127-AA/AM	EC-127-AA/AM	ER-127-AA/AM	E	1.00
300	0.63	300.00	C(H)-152-AA/AM	EC-152-AA/AM	ER-152-AA/AM	E	1.00
350	0.68	350.00	C(H)-177-AA/AM	EC-177-AA/AM	ER-177-AA/AM	E	1.00
400	0.73	400.00	C(H)-203-AA/AM	EC-203-AA/AM	ER-203-AA/AM	E	1.00
450	0.77	450.00	C(H)-229-AA/AM	EC-229-AA/AM	ER-229-AA/AM	G	1.30
500	0.81	500.00	C(H)-253-AA/AM	EC-253-AA/AM	ER-253-AA/AM	G	1.30
550	0.85	550.00	C(H)-279-AA/AM	EC-279-AA/AM	ER-279-AA/AM	G	1.30
600	0.89	600.00	C(H)-304-AA/AM	EC-304-AA/AM	ER-304-AA/AM	G	1.30
650	0.93	650.00	C(H)-329-AA/AM	EC-329-AA/AM	ER-329-AA/AM	G	1.30
700	0.96	700.00	C(H)-355-AA/AM	EC-355-AA/AM	ER-355-AA/AM	G	1.30
750	1.00	750.00	C(H)-380-AA/AM	EC-380-AA/AM	ER-380-AA/AM	K	1.56
800	1.03	800.00	C(H)-405-AA/AM	EC-405-AA/AM	ER-405-AA/AM	K	1.56
850	1.06	850.00	C(H)-431-AA/AM	EC-431-AA/AM	ER-431-AA/AM	K	1.56
875	1.08	875.00	C(H)-442-AA/AM	EC-442-AA/AM	ER-442-AA/AM	K	1.56
900	1.09	900.00	C(H)-456-AA/AM	EC-456-AA/AM	ER-456-AA/AM	K	1.56
950	1.12	950.00	C(H)-481-AA/AM	EC-481-AA/AM	ER-481-AA/AM	K	1.56
1.000	1.15	1000.00	C(H)-507-AA/AM	EC-507-AA/AM	ER-507-AA/AM	L	1.71
1.024	1.16	1024.00	C(H)-520-AA/AM	EC-520-AA/AM	ER-520-AA/AM	L	1.71
1.100	1.21	1100.00	C(H)-557-AA/AM	EC-557-AA/AM	ER-557-AA/AM	L	1.71
1.200	1.26	1200.00	C(H)-608-AA/AM	EC-608-AA/AM	ER-608-AA/AM	N	1.91
1.250	1.29	1250.00	C(H)-633-AA/AM	EC-633-AA/AM	ER-633-AA/AM	N	1.91
1.300	1.31	1300.00	C(H)-659-AA/AM	EC-659-AA/AM	ER-659-AA/AM	N	1.91
1.400	1.36	1400.00	C(H)-709-AA/AM	EC-709-AA/AM	ER-709-AA/AM	N	1.91
1.500	1.41	1500.00	C(H)-760-AA/AM	EC-760-AA/AM	ER-760-AA/AM	P	2.05
1.600	1.46	1600.00	C(H)-811-AA/AM	EC-811-AA/AM	ER-811-AA/AM	P	2.05

ALUMINUM CONDUCTORS ALLOY REINFORCED (ACAR)

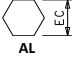
Conductor			Compression Fittings				
Code Word	Ø Ext. (inch)	Size (kcmil)	Compression Dead-end	Compression Joint	Repair Sleeve	Series	
1.700	1.50	1700.00	C(H)-861-AA/AM	EC-861-AA/AM	ER-861-AA/AM	P	2.05
1.750	1.53	1750.00	C(H)-887-AA/AM	EC-887-AA/AM	ER-887-AA/AM	P	2.05
2.000	1.63	2000.00	C(H)-1013-AA/AM	EC-1013-AA/AM	ER-1013-AA/AM	66	2.24

COMPRESSION DEAD ENDS AND JOINTS

COMPRESSION DEAD-ENDS FOR ALUMINUM CONDUCTORS WITH DIAMETER UP TO 0.49 inch.

Material: Body: Aluminum Alloy EN-755 equivalent to ASTM B221 (AAAC, ACAR)
Aluminum. EN-755 equivalent to ASTM B221 (AAC)

Steel parts finish: Hot dip galvanizing CSA-G164 and/or ASTM A153.

Bolt: ASTM A325. **Locking pins:** Stainless steel
Nut: ASTM A563. **Plunger:** Steel EN- 10083 equivalent to ASTM A576).

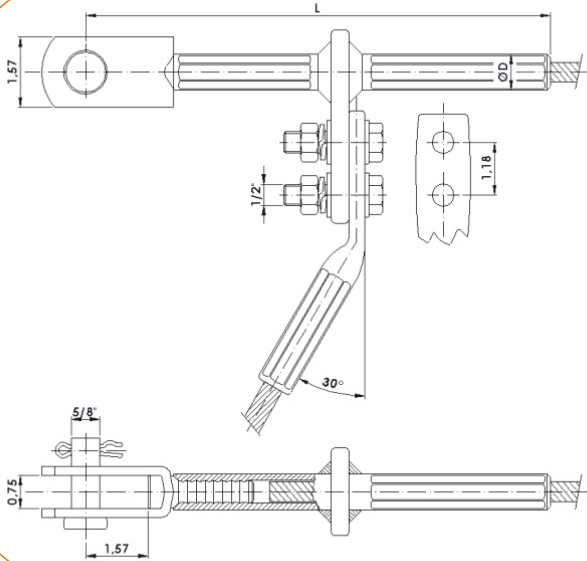

Series	Ø D (inch)	L (inch)		Weight (lb)
		AAAC	ACSR	
B	0.81	10.63	11.81	2.20
D	1.00	12.40	12.40	2.65

NOTE: Other kinds of fasteners upon request.



COMPRESSION MID-SPAN JOINTS FOR ALUMINUM CONDUCTORS WITH DIAMETER UP TO 0.49 inch.



FULL TRACTION JOINTS

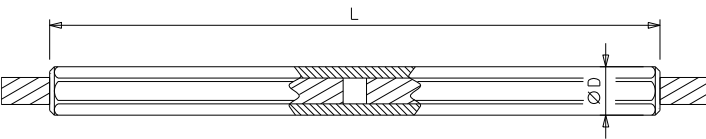

Material: Body: Aluminum Alloy EN-755 equivalent to ASTM B221 (AAAC, ACAR)
Aluminum. EN-755 equivalent to ASTM B221 (AAC)

Series	Ø D (inch)	L (inch)		Weight (lb)
		AAAC	ACSR	
B	0.81	8.46	12.40	0.33-0.55
D	1.00	10.24	13.78	0.55-0.77

REPAIR SLEEVES



Material: Body: Aluminum. EN-755 equivalent to ASTM B221 (AAC)

Series	Ø D (inch)	Ø C (inch)	L (inch)	Weight (lb)
E	1.18	0.75	10.63	0.62
G	1.52	0.98	12.01	1.19
K	1.81	1.18	13.58	1.83
L	1.98	1.30	14.17	2.20
N	2.22	1.46	14.17	2.87
P	2.36	1.63	14.96	3.20

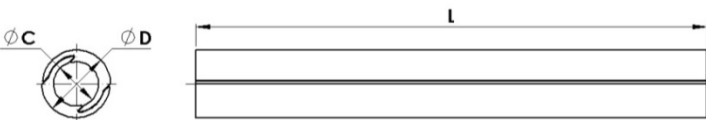

ALUMINUM CONDUCTORS DIAMETER UP TO 0.49 inch (12,50 mm)

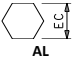
Conductor			Compression Fittings				
Code Word	Ø Ext. (inch)	Size (kcmil)	Compression Dead-end	Compression Joint	Repair Sleeve	Series	
AAC-25	0.25	47.86	CH-25-A/AM	EC-25-A/AM	ER-25-A/AM	B	0.69
AAAC-25	0.25	47.86	CH-25-AA/AM	EC-25-AA/AM	ER-25-AA/AM	B	0.69
ACSR SQUIRREL	0.25	48.21	CH-24/AM	EC-24/AM	ER-24/AM	B	0.69
ACSR SWAN	0.25	48.77	CH-25/AM	EC-25/AM	ER-25/AM	B	0.69
AAAC ALTON	0.25	48.77	CH-24-AA/AM	EC-24-AA/AM	ER-24-AA/AM	B	0.69
AAC GNAT	0.26	52.89	CH-26-A/AM	EC-26-A/AM	ER-26-A/AM	B	0.69
AAC L-28	0.27	54.86	CH-28-A/AM	EC-28-A/AM	ER-28-A/AM	B	0.69
AAAC D-28	0.27	54.86	CH-28-AA/AM	EC-28-AA/AM	ER-28-AA/AM	B	0.69
AAC-27.8	0.27	54.92	CH-27-A/AM	EC-27-A/AM	ER-27-A/AM	B	0.69
ACSR 25/4.0	0.27	54.86	CH-27/AM	EC-27/AM	ER-27/AM	B	0.69
AAAC ALMOND	0.28	59.40	CH-30-AA/AM	EC-30-AA/AM	ER-30-AA/AM	B	0.69
ACSR GOPHER	0.28	60.43	CH-29/AM	EC-29/AM	ER-29/AM	B	0.69
ACSR LA-30	0.28	61.38	CH-30/AM	EC-30/AM	ER-30/AM	B	0.69
ACSR SWALLOW	0.28	61.38	CH-31/AM	EC-31/AM	ER-31/AM	B	0.69
AAC IRIS	0.29	66.33	CH-33-A/AM	EC-33-A/AM	ER-33-A/AM	B	0.69
AAC-34.4	0.30	67.81	CH-34-A/AM	EC-34-A/AM	ER-34-A/AM	B	0.69
ASTER-34.4	0.30	67.81	CH-34-AA/AM	EC-34-AA/AM	ER-34-AA/AM	B	0.69
AAC-35	0.30	67.81	CH-35-A/AM	EC-35-A/AM	ER-35-A/AM	B	0.69
AAAC-35	0.30	67.81	CH-35-AA/AM	EC-35-AA/AM	ER-35-AA/AM	B	0.69
AAAC CEDAR	0.30	70.06	CH-36-AA/AM	EC-36-AA/AM	ER-36-AA/AM	B	0.69
ACSR WEASEL	0.31	72.78	CH-37/AM	EC-37/AM	ER-37/AM	B	0.69
AAC MOSQUITO	0.31	73.02	CH-37-A/AM	EC-37-A/AM	ER-37-A/AM	B	0.69
ACSR SPARROW	0.32	77.40	CH-39/AM	EC-39/AM	ER-39/AM	B	0.69
AAAC AMES	0.32	77.40	CH-39-AA/AM	EC-39-AA/AM	ER-39-AA/AM	B	0.69
ACAR-77.5	0.32	77.56	CH-38-AA/AM	EC-38-AA/AM	ER-38-AA/AM	B	0.69
ACSR 35/6.0	0.32	78.94	CH-40/AM	EC-40/AM	ER-40/AM	B	0.69
AAAC-40	0.32	78.94	CH-41-AA/AM	EC-41-AA/AM	ER-41-AA/AM	B	0.69
ACSR SPARATE	0.32	83.14	CH-42/AM	EC-42/AM	ER-42/AM	B	0.69

ALUMINUM CONDUCTORS DIAMETER UP TO 0.49 inch (12,50 mm)

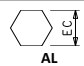
Conductor			Compression Fittings				
Code Word	Ø Ext. (inch)	Size (kcmil)	Compression Dead-end	Compression Joint	Repair Sleeve	Series	
AAC PANSY	0.33	83.66	CH-42-A/AM	EC-42-A/AM	ER-42-A/AM	B	0.69
ACSR FOX	0.33	84.41	CH-43/AM	EC-43/AM	ER-43/AM	B	0.69
AAC L-40	0.33	85.06	CH-40-A/AM	EC-40-A/AM	ER-40-A/AM	B	0.69
AAC D-40	0.33	85.06	CH-40-AA/AM	EC-40-AA/AM	ER-40-AA/AM	B	0.69
AAC-43.1	0.33	85.06	CH-43-A/AM	EC-43-A/AM	ER-43-A/AM	B	0.69
AAAC FIR	0.35	94.33	CH-48-AA/AM	EC-48-AA/AM	ER-48-AA/AM	B	0.69
ACSR FERRET	0.35	97.65	CH-49/AM	EC-49/AM	ER-49/AM	B	0.69
AAC-50	0.35	97.65	CH-50-A/AM	EC-50-A/AM	ER-50-A/AM	B	0.69
AAAC-50	0.35	97.65	CH-50-AA/AM	EC-50-AA/AM	ER-50-AA/AM	B	0.69
ACSR ROBIN	0.35	97.67	CH-50/AM	EC-50/AM	ER-50/AM	B	0.69
AAC ANT	0.37	104.26	CH-53-A/AM	EC-53-A/AM	ER-53-A/AM	B	0.69
ACAR 1/0 AWG	0.37	105.58	CH-53-AA/AM	EC-53-AA/AM	ER-53-AA/AM	B	0.69
AAC-54.6	0.37	107.66	CH-54-A/AM	EC-54-A/AM	ER-54-A/AM	B	0.69
ASTER-54.6	0.37	107.66	CH-54-AA/AM	EC-54-AA/AM	ER-54-AA/AM	B	0.69
ACSR LA-56	0.37	107.75	CH-56/AM	EC-56/AM	ER-56/AM	B	0.69
AAC L-56	0.37	107.75	CH-56-A/AM	EC-56-A/AM	ER-56-A/AM	B	0.69
AAAC D-56	0.37	107.75	CH-56-AA/AM	EC-56-AA/AM	ER-56-AA/AM	B	0.69
ACSR 50/8.0	0.38	111.11	CH-57/AM	EC-57/AM	ER-57/AM	B	0.69
AAAC-HAZEL	0.39	118.21	CH-60-AA/AM	EC-60-AA/AM	ER-60-AA/AM	B	0.69
ACSR RABBIT	0.40	121.77	CH-61/AM	EC-61/AM	ER-61/AM	B	0.69
ACSR RAVEN	0.40	123.11	CH-62/AM	EC-62/AM	ER-62/AM	B	0.69
AAAC AZUSA	0.40	123.11	CH-62-AA/AM	EC-62-AA/AM	ER-62-AA/AM	B	0.69
ACAR-123.3	0.40	123.35	CH-61-AA/AM	EC-61-AA/AM	ER-61-AA/AM	B	0.69
AAAC-63	0.40	124.33	CH-63-AA/AM	EC-63-AA/AM	ER-63-AA/AM	B	0.69
AAC FLY	0.40	125.42	CH-63-A/AM	EC-63-A/AM	ER-63-A/AM	B	0.69
AAC-70	0.41	129.90	CH-70-A/AM	EC-70-A/AM	ER-70-A/AM	B	0.69
AAAC-70	0.41	129.90	CH-70-AA/AM	EC-70-AA/AM	ER-70-AA/AM	B	0.69
AAC ASTER	0.41	133.06	CH-67-A/AM	EC-67-A/AM	ER-67-A/AM	B	0.69

ALUMINUM CONDUCTORS DIAMETER UP TO 0.49 inch (12,50 mm)

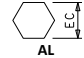
Conductor			Compression Fittings				
Code Word	Ø Ext. (inch)	Size (kcmil)	Compression Dead-end	Compression Joint	Repair Sleeve	Series	
ACAR 2/0 AWG	0.41	133.02	CH-67-AA/AM	EC-67-AA/AM	ER-67-AA/AM	B	0.69
AAC-69.3	0.42	136.73	CH-69-A/AM	EC-69-A/AM	ER-69-A/AM	B	0.69
AAAC PINE	0.43	141.50	CH-72-AA/AM	EC-72-AA/AM	ER-72-AA/AM	B	0.69
ACSR MINK	0.43	145.47	CH-73/AM	EC-73/AM	ER-73/AM	B	0.69
AAC-75.5	0.44	149.08	CH-75-A/AM	EC-75-A/AM	ER-75-A/AM	D	0.87
ASTER-75.5	0.44	149.08	CH-75-AA/AM	EC-75-AA/AM	ER-75-AA/AM	D	0.87
AAC L-80	0.44	149.00	CH-80-A/AM	EC-80-A/AM	ER-80-A/AM	D	0.87
AAAC D-80	0.44	149.00	CH-80-AA/AM	EC-80-AA/AM	ER-80-AA/AM	D	0.87
ACSR LA-78	0.45	155.12	CH-78/AM	EC-78/AM	ER-78/AM	D	0.87
ACSR QUAIL	0.45	155.22	CH-79/AM	EC-79/AM	ER-79/AM	D	0.87
AAAC ANAHEIM	0.45	155.22	CH-79-AA/AM	EC-79-AA/AM	ER-79-AA/AM	D	0.87
ACAR 155.4	0.45	155.32	CH-78-AA/AM	EC-78-AA/AM	ER-78-AA/AM	D	0.87
AAC EARWING	0.45	154.92	CH-78-A/AM	EC-78-A/AM	ER-78-A/AM	D	0.87
AAAC-80	0.45	157.88	CH-81-AA/AM	EC-81-AA/AM	ER-81-AA/AM	D	0.87
AAC GRASSHOPPER	0.46	165.97	CH-84-A/AM	EC-84-A/AM	ER-84-A/AM	D	0.87
ACAR 3/0 AWG	0.46	167,75	CH-85-AA/AM	EC-85-AA/AM	ER-85-AA/AM	D	0.87
AAC PHLOX	0.46	167,81	CH-85-A/AM	EC-85-A/AM	ER-85-A/AM	D	0.87
ACSR BEAVER	0.47	172,27	CH-87/AM	EC-87/AM	ER-87/AM	D	0.87
AAAC WILLOW	0.48	177,22	CH-90-AA/AM	EC-90-AA/AM	ER-90-AA/AM	D	0.87
ASTER-93-3	0.49	184,07	C(H)-93-AA/AM	EC-93-AA/AM	ER-93-AA/AM	D	0.87