



MATERIALS

Steel Alloy.

PROTECTION AGAINST CORROSION

Hot dip galvanizing according to CSA-G164 and ASTM A153 Standards.

STANDARDS

All fittings are manufactured according to IEC 61284 Standard.
Fasteners: galvanized steel as per ASTM A325 and ASTM A563 standards.
Forged material: as per EN-10083 equivalent to ASTM A576 standard.
Locking pins: Stainless steel as per AISI 304.

CLEVIS EYES

Material: Forged steel EN-10083 equivalent to ASTM A576.
Steel parts finish: Hot dip galvanizing CSA-G164 / ASTM A153.

Bolt: ASTM A325.
Nut: ASTM A563.

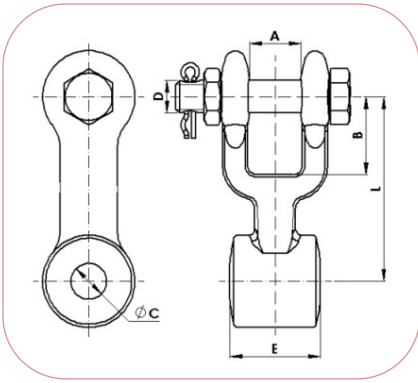

Reference	Dimensions (inch)						Ultimate Strength (lb)	Weight (lb)
	A	B	C	D	E	L		
HP-16/16/AM	0.98	1.50	11/16	5/8	0.63	3.54	30,000	1.76
HP-16/21/AM	0.98	1.50	11/16	5/8	0.83	3.54	30,000	1.90
HP-16/26/AM	0.98	1.50	11/16	5/8	1.02	3.54	30,000	2.01
HP-16/36/AM	0.98	1.50	11/16	5/8	1.42	3.54	30,000	2.25
HP-16/45/AM	0.98	1.50	11/16	5/8	1.77	3.54	30,000	2.38
HP-20/16/AM	0.98	1.50	13/16	3/4	0.63	3.54	40,000	1.94
HP-20/21/AM	0.98	1.50	13/16	3/4	0.83	3.54	40,000	2.05
HP-20/26/AM	0.98	1.50	13/16	3/4	1.02	3.54	40,000	2.16
HP-20/36/AM	0.98	1.50	13/16	3/4	1.42	3.54	40,000	2.38
HP-20/45/AM	0.98	1.50	13/16	3/4	1.77	3.54	40,000	2.51

NOTE: Other dimensions "E" and "C" can be manufactured upon request.
 Special fasteners upon request.



Material: Forged steel EN-10083 equivalent to ASTM A576.
Steel parts finish: Hot dip galvanizing CSA-G164 / ASTM A153.

Bolt: ASTM A325.
Nut: ASTM A563.

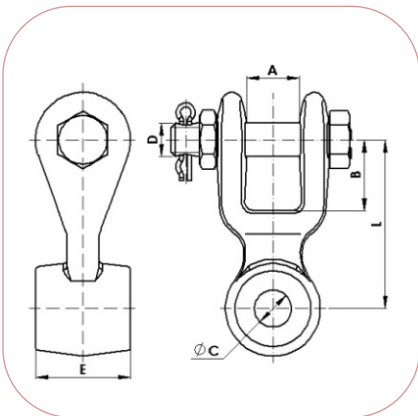

Reference	Dimensions (inch)						Ultimate Strength (lb)	Weight (lb)
	A	B	C	D	E	L		
HR-16/16/AM	0.98	1.34	11/16	5/8	0.63	3.15	30,000	1.61
HR-16/21/AM	0.98	1.34	11/16	5/8	0.83	3.15	30,000	1.70
HR-16/26/AM	0.98	1.34	11/16	5/8	1.02	3.15	30,000	1.79
HR-16/36/AM	0.98	1.34	11/16	5/8	1.42	3.15	30,000	1.98
HR-16/45/AM	0.98	1.34	11/16	5/8	1.77	3.15	30,000	2.14
HR-20/16/AM	0.98	1.34	13/16	3/4	0.63	3.15	40,000	1.76
HR-20/21/AM	0.98	1.34	13/16	3/4	0.83	3.15	40,000	1.85
HR-20/26/AM	0.98	1.34	13/16	3/4	1.02	3.15	40,000	1.94
HR-20/36/AM	0.98	1.34	13/16	3/4	1.42	3.15	40,000	2.12
HR-20/45/AM	0.98	1.34	13/16	3/4	1.77	3.15	40,000	2.27
HR-24/21/AM	1.18	1.77	15/16	7/8	0.83	3.94	54,000	3.28
HR-24/26/AM	1.18	1.77	15/16	7/8	1.02	3.94	54,000	3.40
HR-24/36/AM	1.18	1.77	15/16	7/8	1.42	3.94	54,000	3.59
HR-24/45/AM	1.18	1.77	15/16	7/8	1.77	3.94	54,000	3.77
HR-24/54/AM	1.18	1.77	15/16	7/8	2.13	3.94	54,000	3.95
HR-24-30/21/AM	1.18	1.77	15/16	1	0.83	3.94	68,000	3.51

NOTE: Other dimensions "E" and "C" can be manufactured upon request.
 Special fasteners upon request.



Material: Forged steel EN-10083 equivalent to ASTM A576.
Steel parts finish: Hot dip galvanizing CSA-G164 / ASTM A153.

Bolt: ASTM A325.
Nut: ASTM A563.

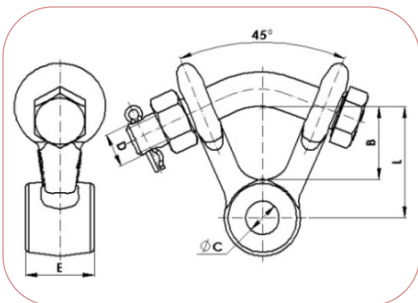

Reference	Dimensions (inch)					Ultimate Strength (lb)	Weight (lb)
	B	C	D	E	L		
HRV-16/16/AM	1.61	11/16	3/4	0.63	2.40	28,000	1.65
HRV-16/16/AM	1.61	11/16	3/4	0.63	2.40	28,000	1.65
HRV-16/21/AM	1.61	11/16	3/4	0.83	2.40	28,000	1.76
HRV-16/36/AM	1.61	11/16	3/4	1.42	2.40	28,000	1.98
HRV-16/45/AM	1.61	11/16	3/4	1.77	2.40	28,000	2.09

NOTE: Other dimensions "E" and "C" can be manufactured upon request.
 Special fasteners upon request.



BALL CLEAVES TYPE "V"

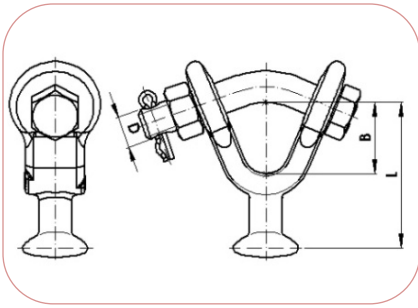

Material: Forged steel EN-10083 equivalent to ASTM A576.
Steel parts finish: Hot dip galvanizing CSA-G164 / ASTM A153.

Bolt: ASTM A325.
Nut: ASTM A563.

Reference	Standard	Dimensions (inch)			Ultimate Strength (lb)	Weight (lb)
		B	D	L		
HB-5/AM	ANSI 52-5	1.38	5/8	2.95	28,000	1.46

NOTE: Special fasteners upon request.



BALL CLEAVES

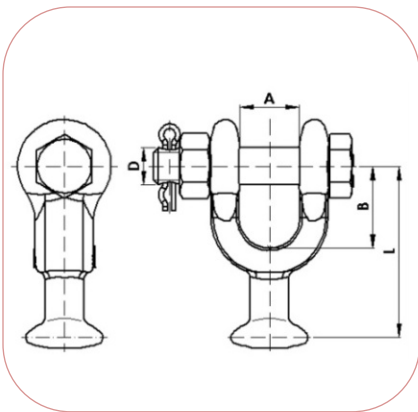

Material: Forged steel EN-10083 equivalent to ASTM A576.
Steel parts finish: Hot dip galvanizing CSA-G164 / ASTM A153.

Bolt: ASTM A325.
Nut: ASTM A563.

Reference	Standard	Dimensions (inch)				Ultimate Strength (lb)	Weight (lb)
		A	B	D	L		
HBP-8/AM	ANSI 52-8	1.02	1.69	3/4	3.68	40,000	2.09

NOTE: Special fasteners upon request.



LONG BALL CLEAVES

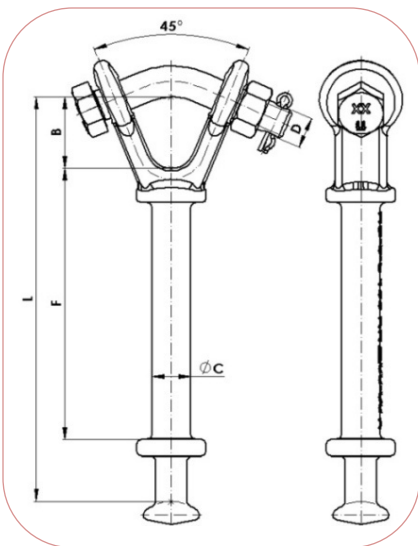

Material: Forged steel EN-10083 equivalent to ASTM A576.
Steel parts finish: Hot dip galvanizing CSA-G164 / ASTM A153.

Bolt: ASTM A325.
Nut: ASTM A563.

Reference	Standard	Dimensions (inch)					Ultimate Strength (lb)	Weight (lb)
		B	C	D	F	L		
HB-5-L/AM	ANSI 52-5	1.61	0.89	3/4	6.14	9.21	30,000	3.24
HB-8-L/AM	ANSI 52-8	1.61	0.89	7/8	6.14	9.37	50,000	4.37

NOTE: Special fasteners upon request.

